

CERTIFIED RECORD OF LAND CORNER MONUMENTATION

T135 R26E

INDEX No. A-23

History of original corner establishment:

In 1869, under General Land Office Contract No. 131, John B. David Established the 1/4. Surveyor Generals Notes State: Set Stone 16x8x7 for 1/4 Sec. Corner.

In 1873 W. Byars, under General Land Office Contract No. 185, retraced this line but could not cross the river and did not find or reestablish this corner.

Later in 1873, J. Owen established a closing corner position (did not monument) at the Northwest corner of section 1. (CC S2/S1) This created a North closing 1/4 corner of section 1, which has not been previously established.

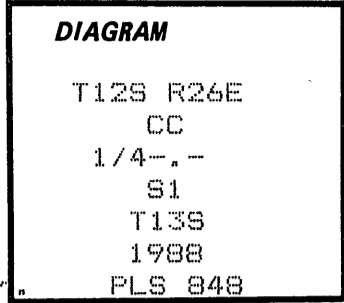

Description of corner evidence found:

No trace of the original 1/4 corner as established by John B. David is found.

This Closing 1/4 corner has not been previously established. Corner position for this survey is established at proportionate measure between the Township corner found 1/2 mi. East and the Standard Corner S35/S36, T125., R26E., Found 1/2 mi. West.

Refer to referenced Map of Survey No. 1050 for details as to this corner.

Description of monument and accessories established to perpetuate the

original location of this corner:

Set 2-1/2"x30" Galvanized Iron Pipe with 2-/12 Brass Cap Stamped as shown in the DIAGRAM set 32" in the ground. (below ground level) From Which:

Set 5/8"x30" iron pins with plastic caps marked PLS 848 as follows: N54°E., 29.0 ft; S54°E., 27.7 ft; , both pins are in West Right of Way Fence of the Franks Cr. Road.

Measurements to pins taken with metal tape and magnetic compass with 20° East Declination set off.

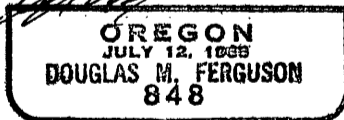
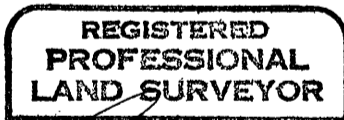

This work is performed by:
Douglas M. Ferguson PLS 848
Mt. Vernon Oregon.
On: July 1988
Refer to Map of Survey No. 1050
Witnesses: D. Mitchell Ferguson & Ken Delano

Office of Surveyor County of Grant
State of Oregon, I hereby certify that the within instrument was filed in this office
for record on the 27 day of Sept, 1988
Robert D. Baggett by _____
(COUNTY OFFICIAL) (DEPUTY)